

Bearing No. 20BTM2612

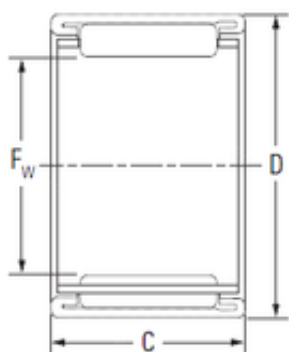

D	26 mm
C	12 mm
Fw	20 mm
Weight	0,014 Kg
Size (mm)	20x26x12
Width (mm)	12
Bearing number	20BTM2612
Bore Diameter (mm)	20
Outer Diameter (mm)	26
Basic dynamic load rating (C)	8,5 kN
Basic static load rating (C0)	12,6 kN