

Bearing No. 20BTM2920

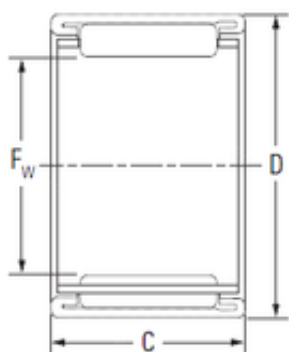

D	29 mm
C	20 mm
Fw	19,5 mm
Weight	0,036 Kg
Size (mm)	19.5x29x20
Width (mm)	20
Bearing number	20BTM2920
Bore Diameter (mm)	19,5
Outer Diameter (mm)	29
Basic dynamic load rating (C)	18,8 kN
Basic static load rating (C0)	23,6 kN