

Bearing No. MH13121

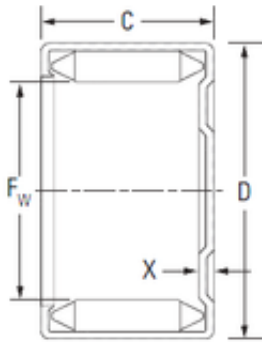

D	28.575 mm
C	19.050 mm
x	2.79 mm
b	16.0 mm
Fw	20.638 mm
Weight	0,038 Kg
Size (mm)	20.638x28.575x19.050
Width (mm)	19.050
Bearing number	MH13121
Bore Diameter (mm)	20.638
Outer Diameter (mm)	28.575
Basic dynamic load rating (C)	21.4 kN
Basic static load rating (C0)	38.8 kN