

Bearing No. M12121

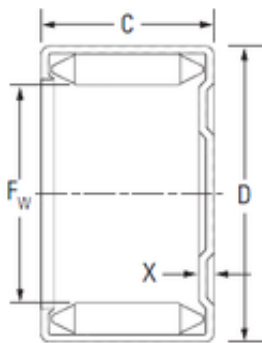

D	25.400 mm
C	19.050 mm
x	2.29 mm
b	16.5 mm
Fw	19.050 mm
Weight	0,028 Kg
Size (mm)	19.050x25.400x19.050
Width (mm)	19.050
Bearing number	M12121
Bore Diameter (mm)	19.050
Outer Diameter (mm)	25.400
Basic dynamic load rating (C)	18.9 kN
Basic static load rating (C0)	38.4 kN