

Bearing No. 48290/48220D+X2S-48290

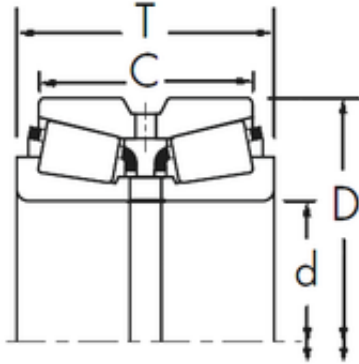

D	182,562 mm
d	127 mm
T	85,728 mm
C	73,025 mm
R	3,5 mm
r	0,8 mm
Size (mm)	127x182.562x85.728
Width (mm)	85,728
Bearing number	48290/48220D+X2S-482 90
Bore Diameter (mm)	127
Outer Diameter (mm)	182,562