

Bearing No. 15TAB04DB-2NK

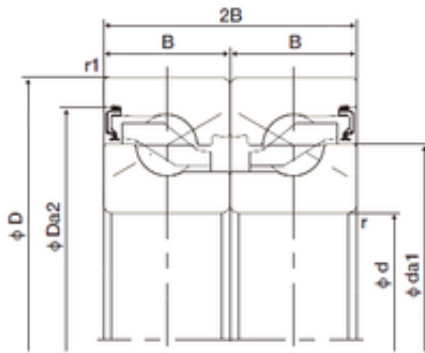

D	47 mm
d	15 mm
B	15 mm
C	15 mm
r1	0.6 mm
2B	30 mm
da2	26.8 mm
da1	33.7 mm
Da2	41.9 mm
Da1	35 mm
Width	15 mm
r min.	1 mm
Weight	0.14 Kg
r1 min.	0.6 mm
Bore Type	Cylindrical Bore
Bore Size	15 mm
Enclosure	Double Seal
Size (mm)	15x47x15
Width (mm)	15
Configuration	Double Row
Bearing number	15TAB04DB-2NK
Angle (?)	60 °
Outside Diameter	47 mm
Static Load Rating	7,200 N
Bore Diameter (mm)	15
Dynamic Load Rating	5,800 N
Outer Diameter (mm)	47
Limiting Speed - Oil	4,400 rpm
Fillet Radius/Chamfer	1 mm
Basic static load rating	32 kN

(C0)	
Basic dynamic load rating (C)	25,9 kN
Starting Torque - Grease Lubrication	15 N·cm