

Bearing No. SILQG12ESA

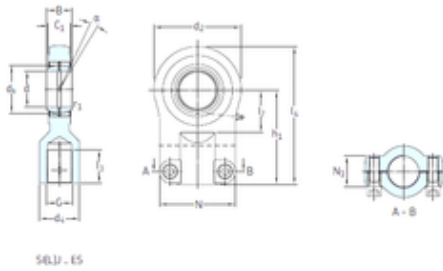

d	12 mm
B	12 mm
d2	33 mm
dk	18 mm
h1	38 mm
Angle	4 °
N max	33 mm
Weight	0,11 Kg
C1 max	11 mm
N1 max	11 mm
l7 min.	13 mm
d4 max.	17 mm
l3 min.	17 mm
l4 max.	55 mm
r1 min.	0,3 mm
Thread (G)	M12x1,25 Tolerance 6H
Bearing number	SILQG12ESA
Bore Diameter (mm)	12
Basic dynamic load rating (C)	10,8 kN