

Bearing No. SILQG25ES

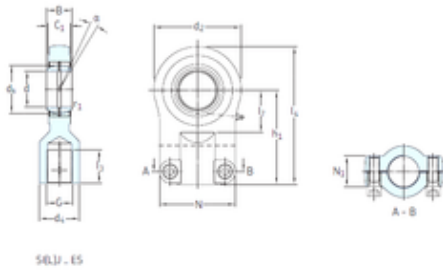

d	25 mm
B	25 mm
d2	59 mm
dk	35,5 mm
h1	65 mm
Angle	4 °
N max	55 mm
Weight	0,66 Kg
C1 max	22 mm
N1 max	18 mm
l7 min.	26 mm
d4 max.	31 mm
l3 min.	29 mm
l4 max.	97 mm
r1 min.	0,6 mm
Thread (G)	M20x1,5 Tolerance 6H
Bearing number	SILQG25ES
Bore Diameter (mm)	25
Basic dynamic load rating (C)	48 kN