

Bearing No. SILJ40ES

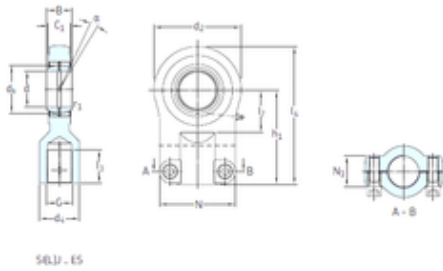

d	40 mm
B	28 mm
d2	98 mm
dk	53 mm
h1	105 mm
Angle	3 °
N max	90 mm
Weight	2,4 Kg
C1 max	23 mm
N1 max	23 mm
l7 min.	45 mm
d4 max.	45 mm
l3 min.	37 mm
l4 max.	155 mm
r1 min.	0,6 mm
Thread (G)	M27x2 Tolerance 6H
Bearing number	SILJ40ES
Bore Diameter (mm)	40
Basic dynamic load rating (C)	100 kN