

Bearing No. SILJ50ES

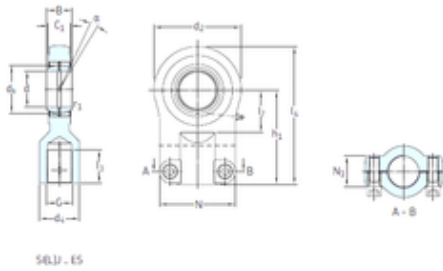

d	50 mm
B	35 mm
d2	122 mm
dk	66 mm
h1	130 mm
Angle	3 °
N max	105 mm
Weight	3,8 Kg
C1 max	30 mm
N1 max	30 mm
l7 min.	58 mm
d4 max.	55 mm
l3 min.	46 mm
l4 max.	192,5 mm
r1 min.	0,6 mm
Thread (G)	M33x2 Tolerance 6H
Bearing number	SILJ50ES
Bore Diameter (mm)	50
Basic dynamic load rating (C)	156 kN