

### Bearing No. SILJ12E

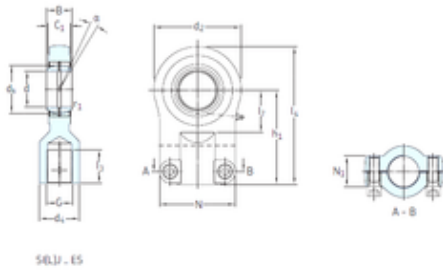

d	12 mm
B	10 mm
d2	36 mm
dk	18 mm
h1	42 mm
Angle	3 °
N max	40 mm
Weight	0,14 Kg
C1 max	8 mm
N1 max	13 mm
l7 min.	16 mm
d4 max.	17 mm
l3 min.	15 mm
l4 max.	62 mm
r1 min.	0,3 mm
Thread (G)	M10x1,25 Tolerance 6H
Bearing number	SILJ12E
Bore Diameter (mm)	12
Basic dynamic load rating (C)	10,8 kN