

### Bearing No. SILJ25ES

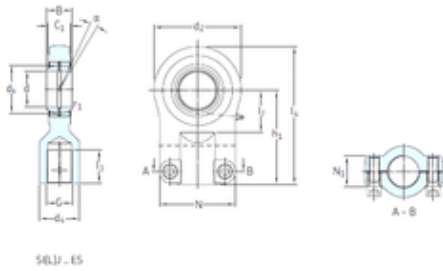

|                               |                      |
|-------------------------------|----------------------|
| d                             | 25 mm                |
| B                             | 20 mm                |
| d2                            | 65 mm                |
| dk                            | 35,5 mm              |
| h1                            | 68 mm                |
| Angle                         | 3 °                  |
| N max                         | 62 mm                |
| Weight                        | 0,68 Kg              |
| C1 max                        | 17 mm                |
| N1 max                        | 17 mm                |
| l7 min.                       | 30 mm                |
| d4 max.                       | 30 mm                |
| l3 min.                       | 23 mm                |
| l4 max.                       | 100,5 mm             |
| r1 min.                       | 0,6 mm               |
| Thread (G)                    | M16x1,5 Tolerance 6H |
| Bearing number                | SILJ25ES             |
| Bore Diameter (mm)            | 25                   |
| Basic dynamic load rating (C) | 48 kN                |