

### Bearing No. SILJ30ES

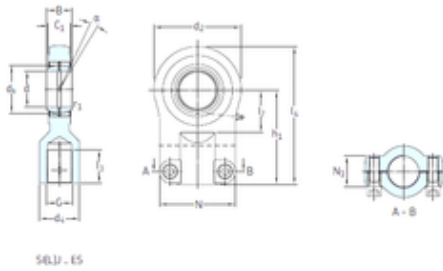

d	30 mm
B	22 mm
d2	80 mm
dk	40,7 mm
h1	85 mm
Angle	3 °
N max	80 mm
Weight	1,35 Kg
C1 max	19 mm
N1 max	19 mm
l7 min.	35 mm
d4 max.	36 mm
l3 min.	29 mm
l4 max.	125 mm
r1 min.	0,6 mm
Thread (G)	M20x1,5 Tolerance 6H
Bearing number	SILJ30ES
Bore Diameter (mm)	30
Basic dynamic load rating (C)	62 kN