

Bearing No. AST650 637560

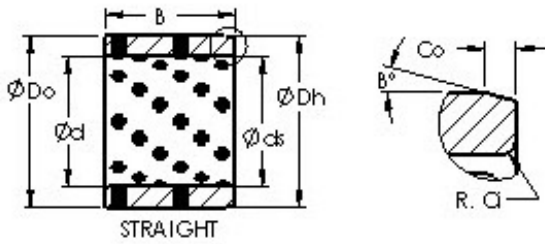

Material	Cast bronze with solid lubricant inserts.
Bearing Type	straight
Bearing number	AST650 637560
Bore Diameter (mm)	63
Outer Diameter (mm)	75
OD Chamfer Length (Co)	3.000
ID Chamfer Length (Ci)	1.200
Shaft Dia., Nominal (d)	63.0000
ID Chamfer Angle (B deg.)	15
Bearing Length, Nominal (B)	60.000
Bearing Bore after Mounting (di)	63 +0.080 / +0.030
Bearing Outside Diameter, Nominal(Do)	75.000
Housing Bore Dia. (Dh) - 75 +0.030 / -0	75 +0.030 / 0
Bearing Outside Diameter Tolerance (Do tol.)	75 +0.030 / +0.011
Bearing Length Tolerance (B tol.) - -0.10 / -0.30	0.10 / 0.30