

Bearing No. 30BTM3726

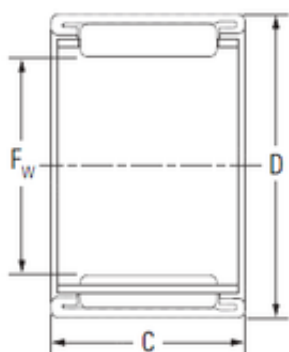

D	37 mm
C	26 mm
Fw	30 mm
Weight	0,048 Kg
Size (mm)	30x37x26
Width (mm)	26
Bearing number	30BTM3726
Bore Diameter (mm)	30
Outer Diameter (mm)	37
Basic dynamic load rating (C)	26,7 kN
Basic static load rating (C0)	52 kN