

Bearing No. 51201V/HR22Q2

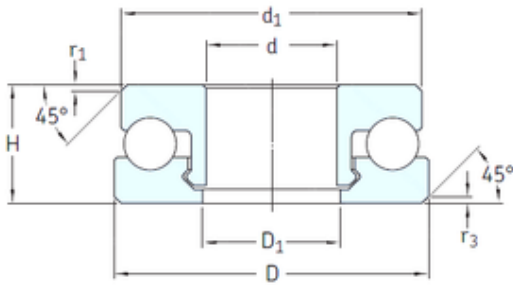

D	28 mm
d	12 mm
H	11 mm
d1	27 mm
D1	13 mm
Weight	0,0067 Kg
r1 min.	0,2 mm
r3 min.	0,5 mm
Size (mm)	12x28x11
Width (mm)	11
Bearing number	51201V/HR22Q2
Bore Diameter (mm)	12
Outer Diameter (mm)	28
Basic dynamic load rating (C)	0,36 kN
Basic static load rating (C0)	0,29 kN