

Bearing No. 51205V/HR11T1

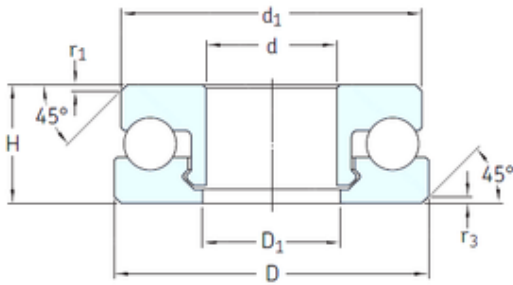

D	47 mm
d	25 mm
H	15 mm
d1	46 mm
D1	26 mm
Weight	0,0285 Kg
r1 min.	0,5 mm
r3 min.	0,5 mm
Size (mm)	25x47x15
Width (mm)	15
Bearing number	51205V/HR11T1
Bore Diameter (mm)	25
Outer Diameter (mm)	47
Basic dynamic load rating (C)	0,93 kN
Basic static load rating (C0)	0,75 kN