

**Bearing No. 15BTM2016C-2**

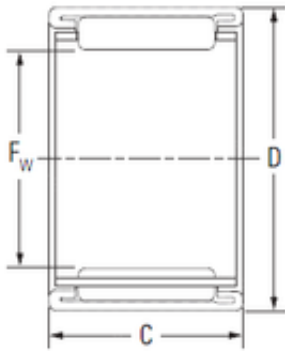

D	20 mm
C	16 mm
Fw	15 mm
Weight	0,012 Kg
Size (mm)	15x20x16
Width (mm)	16
Bearing number	15BTM2016C-2
Bore Diameter (mm)	15
Outer Diameter (mm)	20
(Grease) Lubrication Speed	15000 r/min
Basic dynamic load rating (C)	8,15 kN
Basic static load rating (C0)	12,6 kN