

Bearing No. 15BTM2112-1

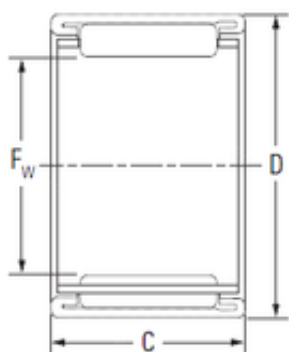

D	21 mm
C	12 mm
Fw	15 mm
Weight	0,011 Kg
Size (mm)	15x21x12
Width (mm)	12
Bearing number	15BTM2112-1
Bore Diameter (mm)	15
Outer Diameter (mm)	21
Basic dynamic load rating (C)	7 kN
Basic static load rating (C0)	8,8 kN