

**Bearing No. 32BTM4025PL**

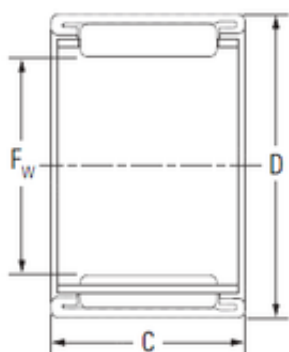

D	40 mm
C	25 mm
Fw	32 mm
Weight	0,057 Kg
Size (mm)	32x40x25
Width (mm)	25
Bearing number	32BTM4025PL
Bore Diameter (mm)	32
Outer Diameter (mm)	40
Basic dynamic load rating (C)	27,6 kN
Basic static load rating (C0)	50,8 kN