

**Bearing No. 34BTM4012A**

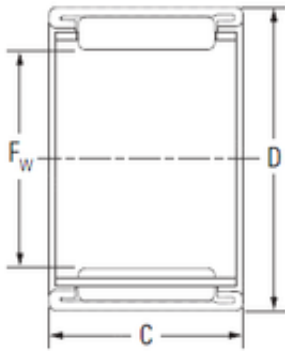

D	40 mm
C	12 mm
Fw	34 mm
Weight	0,02 Kg
Size (mm)	34x40x12
Width (mm)	12
Bearing number	34BTM4012A
Bore Diameter (mm)	34
Outer Diameter (mm)	40
Basic dynamic load rating (C)	7,3 kN
Basic static load rating (C0)	11,7 kN