

**Bearing No. 36BTM4824**

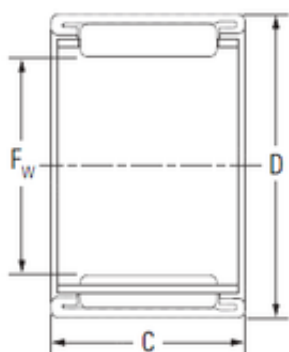

D	48 mm
C	24 mm
Fw	36 mm
Weight	0,095 Kg
Size (mm)	36x48x24
Width (mm)	24
Bearing number	36BTM4824
Bore Diameter (mm)	36
Outer Diameter (mm)	48
Basic dynamic load rating (C)	33,2 kN
Basic static load rating (C0)	48,7 kN