

**Bearing No. 40BTM4712A**

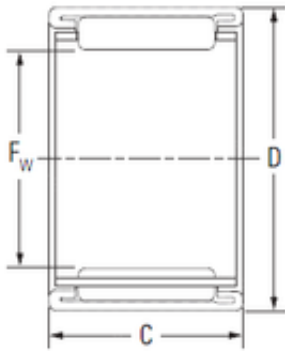

D	47 mm
C	12 mm
Fw	40 mm
Weight	0,027 Kg
Size (mm)	40x47x12
Width (mm)	12
Bearing number	40BTM4712A
Bore Diameter (mm)	40
Outer Diameter (mm)	47
Basic dynamic load rating (C)	9,75 kN
Basic static load rating (C0)	10,4 kN