

Bearing No. 40BTM4720

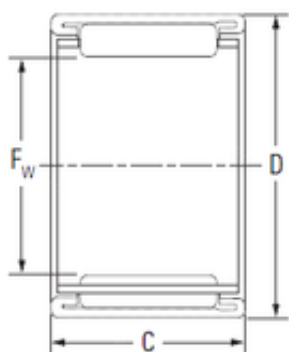

D	47 mm
C	20 mm
Fw	40 mm
Weight	0,048 Kg
Size (mm)	40x47x20
Width (mm)	20
Bearing number	40BTM4720
Bore Diameter (mm)	40
Outer Diameter (mm)	47
Basic dynamic load rating (C)	23,7 kN
Basic static load rating (C0)	50,4 kN