

**Bearing No. 12BTM1810**

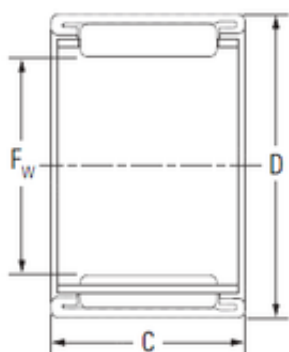

|                               |           |
|-------------------------------|-----------|
| D                             | 18 mm     |
| C                             | 10 mm     |
| Fw                            | 12 mm     |
| Weight                        | 0,0072 Kg |
| Size (mm)                     | 12x18x10  |
| Width (mm)                    | 10        |
| Bearing number                | 12BTM1810 |
| Bore Diameter (mm)            | 12        |
| Outer Diameter (mm)           | 18        |
| Basic dynamic load rating (C) | 4,6 kN    |
| Basic static load rating (C0) | 4,8 kN    |