

Bearing No. PBR16FN

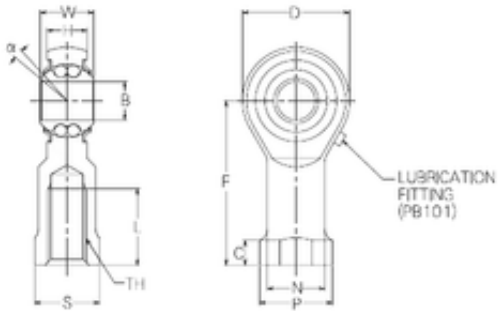

H	15 mm
d	16 mm
P	27 mm
B	16 mm
C	8 mm
D	42 mm
F	64 mm
L	28 mm
N	22 mm
S	22 mm
W	21 mm
Angle	8 °
Weight	224 Kg
Width (mm)	16
Thread (TH)	M16x2,0
Bearing number	PBR16FN
Bore Diameter (mm)	16
Basic dynamic load rating (C)	6,24 kN