

**Bearing No. BTM101415**

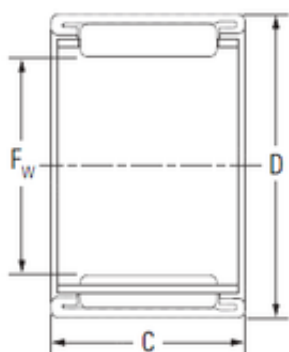

D	14 mm
C	15 mm
Fw	10 mm
Weight	0,0064 Kg
Size (mm)	10x14x15
Width (mm)	15
Bearing number	BTM101415
Bore Diameter (mm)	10
Outer Diameter (mm)	14
Basic dynamic load rating (C)	5,65 kN
Basic static load rating (C0)	8,25 kN