

**Bearing No. BTM172425**

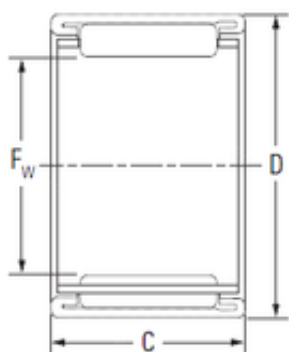

D	24 mm
C	25 mm
Fw	17 mm
Weight	0,022 Kg
Size (mm)	17x24x25
Width (mm)	25
Bearing number	BTM172425
Bore Diameter (mm)	17
Outer Diameter (mm)	24
Basic dynamic load rating (C)	19 kN
Basic static load rating (C0)	29 kN