

Bearing No. BTM1815

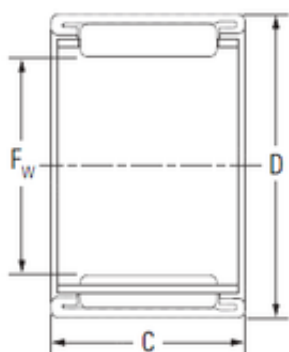

D	25 mm
C	15 mm
Fw	18 mm
Weight	0,018 Kg
Size (mm)	18x25x15
Width (mm)	15
Bearing number	BTM1815
Bore Diameter (mm)	18
Outer Diameter (mm)	25
Basic dynamic load rating (C)	10,4 kN
Basic static load rating (C0)	9,25 kN