

**Bearing No. BTM1825A**

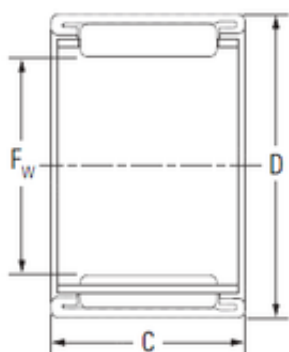

|                               |          |
|-------------------------------|----------|
| D                             | 25 mm    |
| C                             | 25 mm    |
| Fw                            | 18 mm    |
| Weight                        | 0,029 Kg |
| Size (mm)                     | 18x25x25 |
| Width (mm)                    | 25       |
| Bearing number                | BTM1825A |
| Bore Diameter (mm)            | 18       |
| Outer Diameter (mm)           | 25       |
| Basic dynamic load rating (C) | 18,9 kN  |
| Basic static load rating (C0) | 29,2 kN  |