

Bearing No. BTM2015

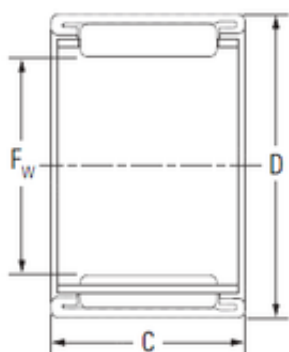

D	27 mm
C	15 mm
Fw	20 mm
Weight	0,02 Kg
Size (mm)	20x27x15
Width (mm)	15
Bearing number	BTM2015
Bore Diameter (mm)	20
Outer Diameter (mm)	27
Basic dynamic load rating (C)	13,1 kN
Basic static load rating (C0)	18,7 kN