

Bearing No. BTM2212

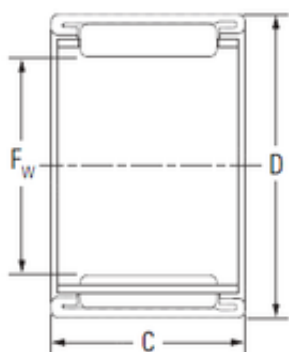

D	29 mm
C	12 mm
Fw	22 mm
Weight	0,019 Kg
Size (mm)	22x29x12
Width (mm)	12
Bearing number	BTM2212
Bore Diameter (mm)	22
Outer Diameter (mm)	29
Basic dynamic load rating (C)	9,22 kN
Basic static load rating (C0)	13 kN