

Bearing No. BTM2215

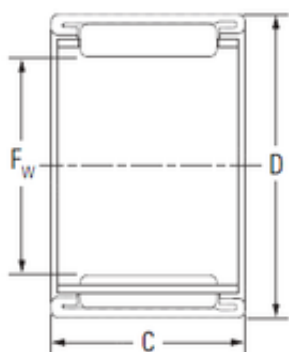

D	29 mm
C	15 mm
Fw	22 mm
Weight	0,022 Kg
Size (mm)	22x29x15
Width (mm)	15
Bearing number	BTM2215
Bore Diameter (mm)	22
Outer Diameter (mm)	29
Basic dynamic load rating (C)	12 kN
Basic static load rating (C0)	18,3 kN