

Bearing No. BTM222712A

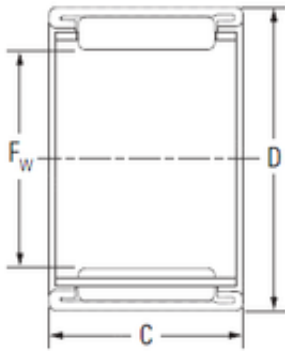

D	26.645 mm
C	12.4 mm
Fw	21.6 mm
Weight	0.012 Kg
Size (mm)	21.6x26.645x12.4
Width (mm)	12.4
Bearing number	BTM222712A
Bore Diameter (mm)	21.6
Outer Diameter (mm)	26.645
(Grease) Lubrication Speed	9800 r/min
Basic dynamic load rating (C)	9.15 kN
Basic static load rating (C0)	13.9 kN