

Bearing No. BTM2420

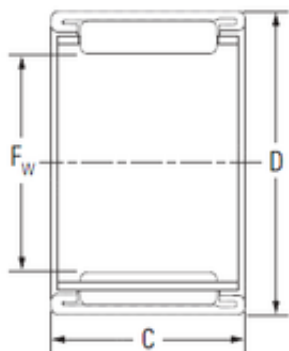

D	31 mm
C	20 mm
Fw	24 mm
Weight	0,031 Kg
Size (mm)	24x31x20
Width (mm)	20
Bearing number	BTM2420
Bore Diameter (mm)	24
Outer Diameter (mm)	31
Basic dynamic load rating (C)	17,7 kN
Basic static load rating (C0)	29,4 kN