

Bearing No. BTM2428

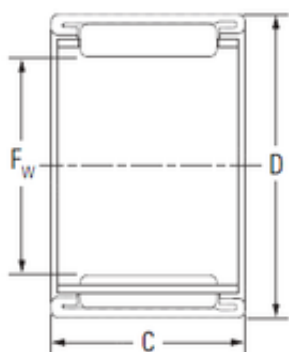

D	31 mm
C	28 mm
Fw	24 mm
Weight	0,044 Kg
Size (mm)	24x31x28
Width (mm)	28
Bearing number	BTM2428
Bore Diameter (mm)	24
Outer Diameter (mm)	31
Basic dynamic load rating (C)	23,9 kN
Basic static load rating (C0)	43 kN