

Bearing No. BTM2516

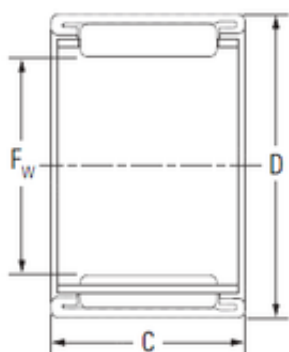

D	32 mm
C	16 mm
Fw	25 mm
Weight	0,026 Kg
Size (mm)	25x32x16
Width (mm)	16
Bearing number	BTM2516
Bore Diameter (mm)	25
Outer Diameter (mm)	32
Basic dynamic load rating (C)	15,3 kN
Basic static load rating (C0)	24,6 kN