

**Bearing No. BTM2520A**

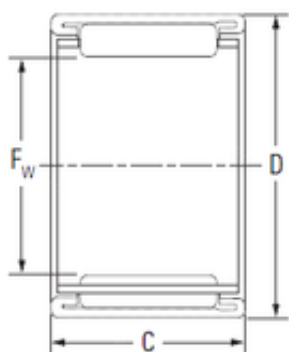

D	32 mm
C	20 mm
Fw	25 mm
Weight	0,033 Kg
Size (mm)	25x32x20
Width (mm)	20
Bearing number	BTM2520A
Bore Diameter (mm)	25
Outer Diameter (mm)	32
Basic dynamic load rating (C)	19,1 kN
Basic static load rating (C0)	32,5 kN