

Bearing No. BTM283623J

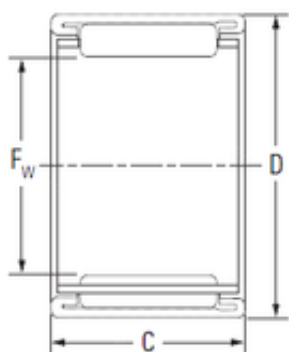

D	36 mm
C	23 mm
Fw	28 mm
Weight	0,049 Kg
Size (mm)	28x36x23
Width (mm)	23
Bearing number	BTM283623J
Bore Diameter (mm)	28
Outer Diameter (mm)	36
Basic dynamic load rating (C)	22,8 kN
Basic static load rating (C0)	39,3 kN