

**Bearing No. BTM3021A**

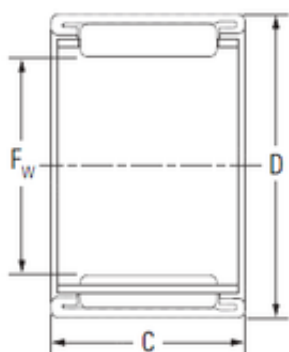

D	38 mm
C	21 mm
Fw	30 mm
Weight	0,045 Kg
Size (mm)	30x38x21
Width (mm)	21
Bearing number	BTM3021A
Bore Diameter (mm)	30
Outer Diameter (mm)	38
Basic dynamic load rating (C)	23,4 kN
Basic static load rating (C0)	40,4 kN