

### Bearing No. BTM3520

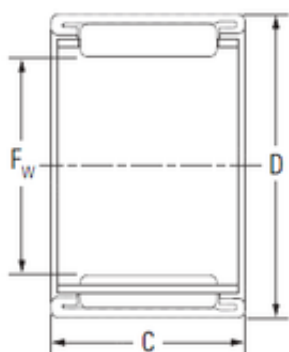

D	42 mm
C	20 mm
Fw	35 mm
Weight	0,043 Kg
Size (mm)	35x42x20
Width (mm)	20
Bearing number	BTM3520
Bore Diameter (mm)	35
Outer Diameter (mm)	42
Basic dynamic load rating (C)	23,4 kN
Basic static load rating (C0)	47 kN