

### Bearing No. BTM3526

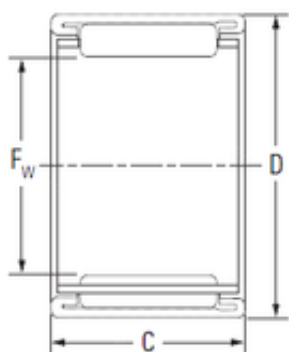

D	42 mm
C	26 mm
Fw	35 mm
Weight	0,057 Kg
Size (mm)	35x42x26
Width (mm)	26
Bearing number	BTM3526
Bore Diameter (mm)	35
Outer Diameter (mm)	42
Basic dynamic load rating (C)	30,1 kN
Basic static load rating (C0)	65,2 kN