

Bearing No. BTM3528

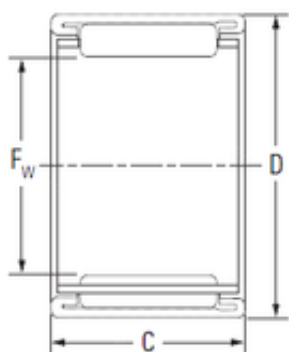

D	42 mm
C	28 mm
Fw	35 mm
Weight	0,063 Kg
Size (mm)	35x42x28
Width (mm)	28
Bearing number	BTM3528
Bore Diameter (mm)	35
Outer Diameter (mm)	42
Basic dynamic load rating (C)	31,3 kN
Basic static load rating (C0)	68,6 kN