

Bearing No. BTM3720

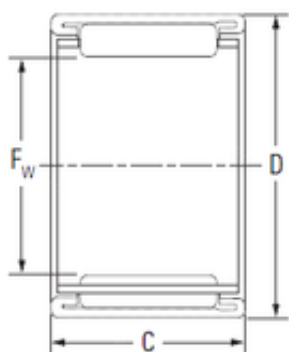

D	47 mm
C	20 mm
Fw	37 mm
Weight	0,064 Kg
Size (mm)	37x47x20
Width (mm)	20
Bearing number	BTM3720
Bore Diameter (mm)	37
Outer Diameter (mm)	47
Basic dynamic load rating (C)	25,1 kN
Basic static load rating (C0)	39,9 kN