

Bearing No. BTM3820A

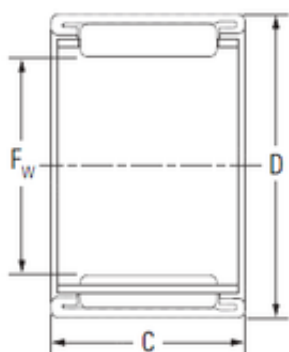

D	48 mm
C	20 mm
Fw	38 mm
Weight	0,067 Kg
Size (mm)	38x48x20
Width (mm)	20
Bearing number	BTM3820A
Bore Diameter (mm)	38
Outer Diameter (mm)	48
Basic dynamic load rating (C)	27,1 kN
Basic static load rating (C0)	44,5 kN