

**Bearing No. BTM3845-OH**

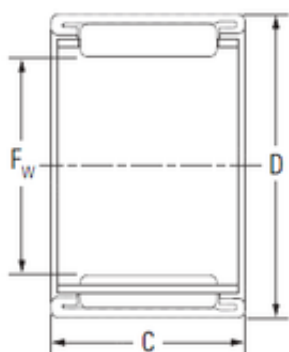

D	48 mm
C	45 mm
Fw	38 mm
Weight	0,151 Kg
Size (mm)	38x48x45
Width (mm)	45
Bearing number	BTM3845-OH
Bore Diameter (mm)	38
Outer Diameter (mm)	48
Basic dynamic load rating (C)	58,9 kN
Basic static load rating (C0)	121 kN