

Bearing No. BTM4020

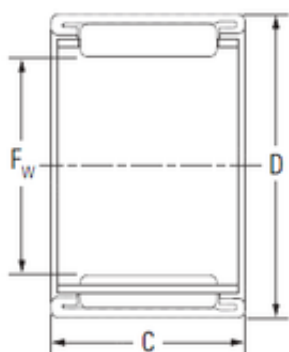

D	50 mm
C	20 mm
Fw	40 mm
Weight	0,073 Kg
Size (mm)	40x50x20
Width (mm)	20
Bearing number	BTM4020
Bore Diameter (mm)	40
Outer Diameter (mm)	50
Basic dynamic load rating (C)	28,5 kN
Basic static load rating (C0)	48,5 kN