

Bearing No. BTM4025

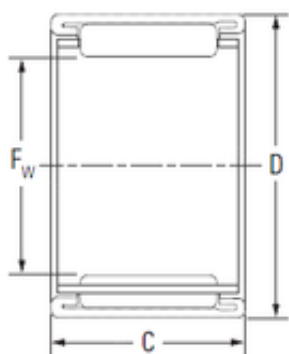

D	50 mm
C	25 mm
Fw	40 mm
Weight	0,091 Kg
Size (mm)	40x50x25
Width (mm)	25
Bearing number	BTM4025
Bore Diameter (mm)	40
Outer Diameter (mm)	50
Basic dynamic load rating (C)	36,2 kN
Basic static load rating (C0)	66,2 kN