

**Bearing No. BTM4030-1**

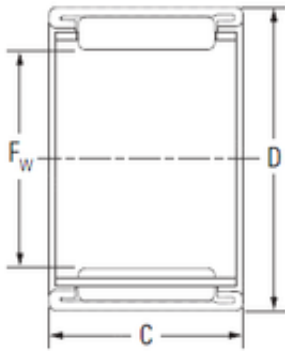

D	50 mm
C	30 mm
Fw	40 mm
Weight	0,109 Kg
Size (mm)	40x50x30
Width (mm)	30
Bearing number	BTM4030-1
Bore Diameter (mm)	40
Outer Diameter (mm)	50
Basic dynamic load rating (C)	43 kN
Basic static load rating (C0)	82,5 kN