

Bearing No. BTM4520A

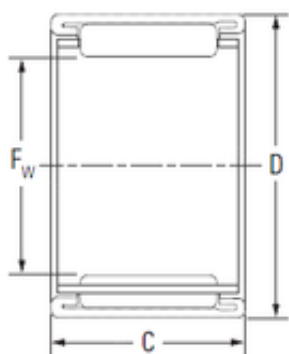

D	55 mm
C	20 mm
Fw	45 mm
Weight	0,079 Kg
Size (mm)	45x55x20
Width (mm)	20
Bearing number	BTM4520A
Bore Diameter (mm)	45
Outer Diameter (mm)	55
Basic dynamic load rating (C)	30 kN
Basic static load rating (C0)	53,9 kN